

RoHS
COMPLIANT

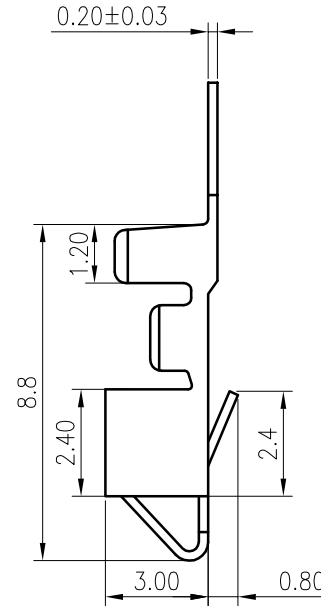
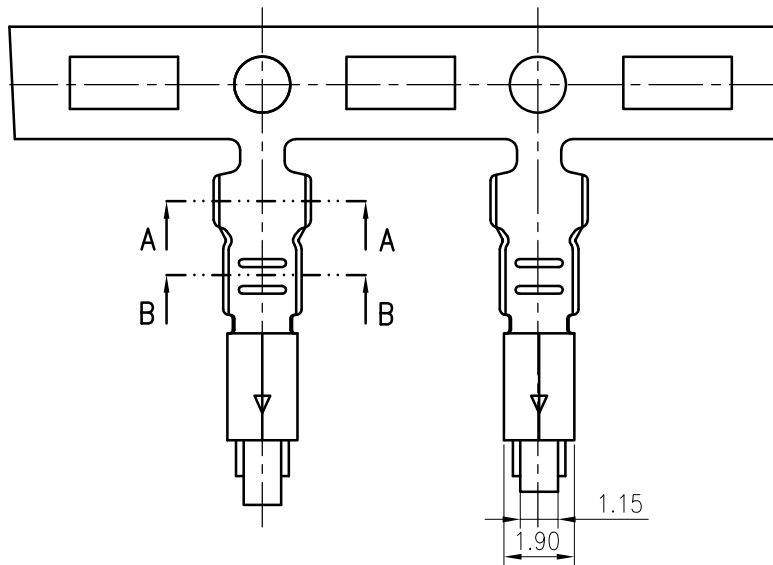

SPECIFICATIONS

1. Current rating: 3A AC, DC
2. Voltage rating: 250V AC,DC
3. Temperature range: -40°C ~ +105°C
4. Insulation resistance: 500MΩ Min.
5. Withstanding voltage: 1500V AC/ minute.
6. Contact resistance: 10mΩ Max.

Applicable Wires:

AWG#22~#28

Insulation O.D. : 1.60mm MAX

Material: Phosphor Bronze

Plating: Tin plated over nickel

Suitable KR2507 series male housing

Q'ty/reel: 5,000 PCS

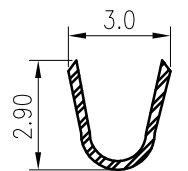

SECTION A-A

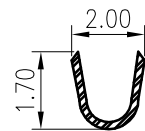

SECTION B-B

F					TOLERANCE X.X ±0.30 X.XX ±0.20 X.XXX ±0.10 Angle ±2°	TITLE: SM2.5 Female Terminal	DRAWN: Liujingtian 2020.5.08		KONNRA 东莞市康瑞电子有限公司		
		Uniformly arrange the drawings	LJT	2020.05.08			CHECKED:		DongGuan Konnra Electronics Co.,Ltd.		
	MARK	REVISION DESCRIPTION	SIGNATURE	DATE		UNIT: mm	SCALE: N/A	SHEET: 1/1	PROJECTION	REV. : A2	DRAWING NO. : 2507TF101-C-S
	1	2	3	4	5	6	7	8	9		